

**SHELTER**  
**HOME SYSTEMS**

Proudly made in  
Canada  
to Canadian  
Standards

# The Ambassador Prairie Series

*16' Wide Homes*



**SRI**  
**H O M E S**

# The Ambassador Prairie Series

**PR-1051, 16' x 60', 2FL-1B**

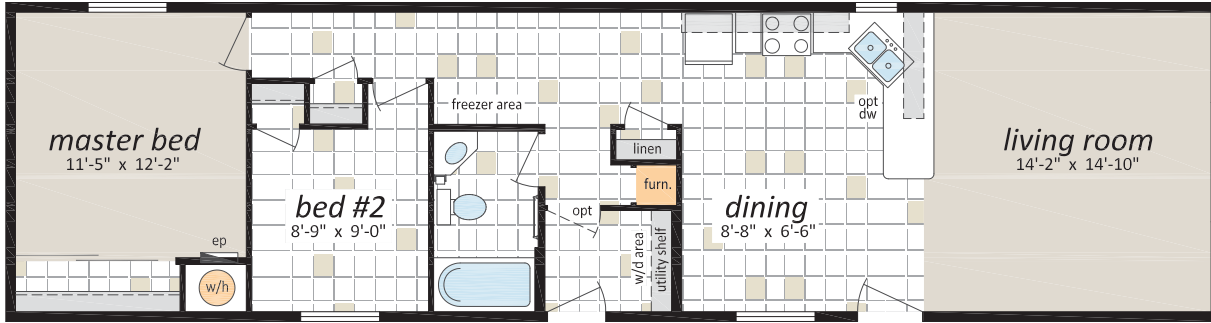

**PR-1052, 16' x 60', 2FB-1B**

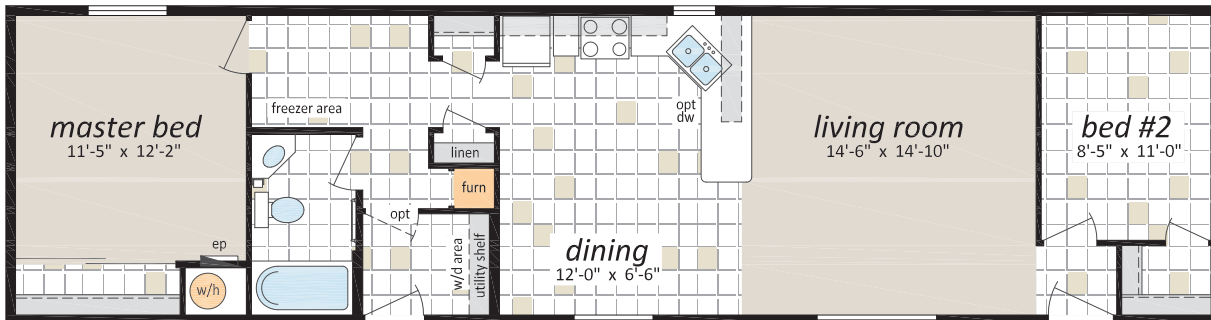

**PR-1053, 16' x 68', 3FL-1B**

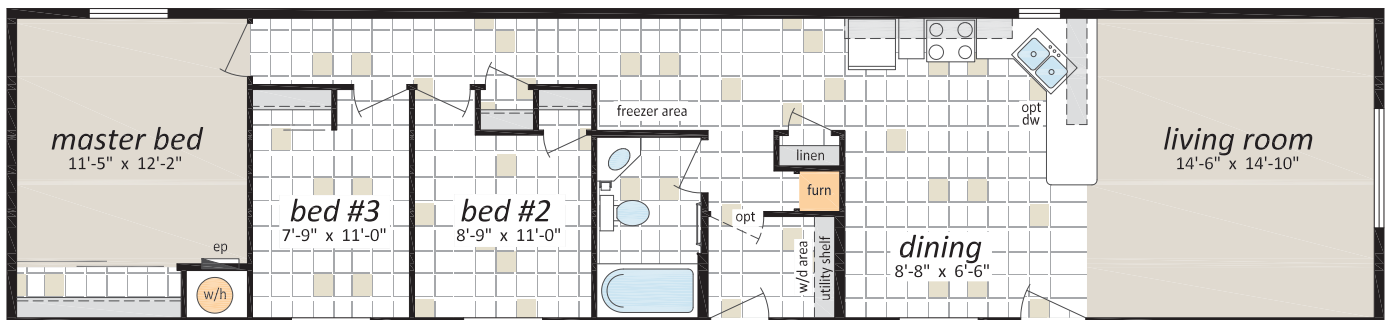

# The Ambassador Prairie Series

**PR-1054, 16' x 68', 3FB-1B**

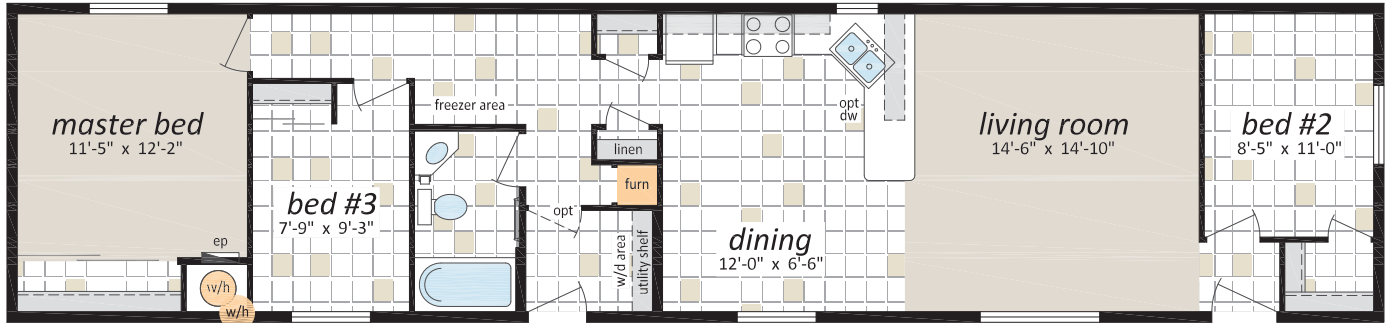

**PR-1055, 16' x 76', 3FB-2B**

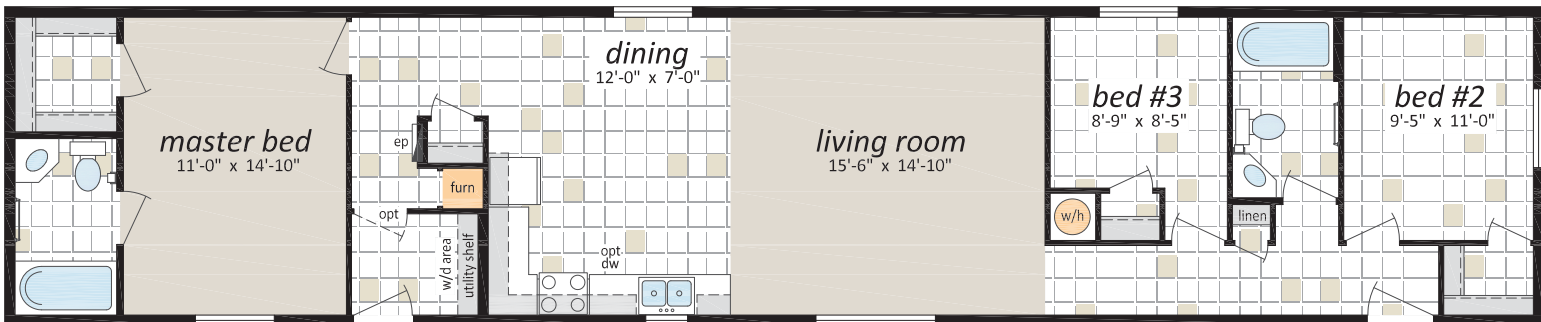

# The Ambassador Prairie Series

## Standard Features and Specifications

### Exterior

- ▲ Asphalt Shingled Roof
- ▲ Engineered Roof Trusses
- ▲ Perimeter Eaves and Ridge Cap Venting
- ▲ Maintenance Free Full Vinyl Siding
- ▲ White Thermopane Windows with Screens
- ▲ Weatherproof Exterior Receptacle protected with GFI
- ▲ 36" Insulated Front Door with Peephole & Deadbolt
- ▲ 32" Insulated Rear Door with Peephole & Deadbolt
- ▲ Frost Free Exterior Tap with check valve
- ▲ Separate Receptacle for Heat Tape
- ▲ 2x6 Exterior Walls with Belt Rails
- ▲ 2x10 Floor Joists
- ▲ "Sturdi-Wall" Construction
- ▲ Coach Lights at all Exterior Doors

### Interior

- ▲ 5/8" Cresdek floor Decking (Screwed & Glued)
- ▲ R-34 Insulation in Ceilings
- ▲ R-20 Insulation in Walls
- ▲ R-26 Insulation in Floors
- ▲ Attractive Textured Gyproc Ceilings
- ▲ Designer Drapery Package
- ▲ 6 Mil Poly Vapor Barrier in Ceilings and Walls
- ▲ 100% Nylon Carpet in Living Room and Master Bedroom
- ▲ No Wax Quality Vinyl Floor Coverings
- ▲ Pre-Finished Interior Doors
- ▲ Decorative Vinyl covered Drywall
- ▲ Wire Closet Shelving
- ▲ Wire Shelf above Washer and Dryer

### Kitchen

- ▲ 18 cu. ft. Frost Free Refrigerator
- ▲ 30" Glass Door Electric Range
- ▲ 2-Speed Rangehood Vented to Exterior
- ▲ Rolled Drawer Hardware
- ▲ Double Stainless Steel Sink
- ▲ Roughed In for Dishwasher

### Bathroom

- ▲ GFI protected Receptacle
- ▲ Shower Rod and Curtain in all Bathrooms
- ▲ Chrome Towel Bar and Paper Holder
- ▲ White Bathroom Fixtures
- ▲ Dehumidistat on Main Bath Fan
- ▲ Shut off valves on all toilets
- ▲ Shower Heads in Baths

### Utilities

- ▲ 40 Gallon Electric Water Heater
- ▲ Natural Gas Furnace with Electronic Ignition
- ▲ Life Saving Smoke Detector(s)
- ▲ Plumbed and Wired for Washer & Dryer
- ▲ 100 amp. Service Panel
- ▲ Electrical Conduit through Floor
- ▲ Copper Wiring Throughout
- ▲ Light Bulb Package
- ▲ Built to Meet or Exceed Applicable Provincial Codes

## Optional Features

### Exterior

- 14' Dormer in Living Room
- Door Chimes at Front and Rear Doors
- Proguard Roof Membrane
- Residential Eaves
- Turbine Vent(s)
- Vinyl Shutters
- Heavy Snow Load Roof
- R-40 Insulation in Ceiling

### Interior

- 36" Exterior Door ILO 32" Door
- 9 Light Exterior Door
- Utility Room Door c/w Grill
- Aluminum Storm Door(s)
- Skylight(s)
- Deluxe Package - Cathedral Ceiling in Living Room and Kitchen
- Raised Panel Cabinet Doors throughout Home

### Kitchen

- Built-In Dishwasher
- Dishwasher Ready
- Self Cleaning Range

### Utilities

- Washer & Dryer
- 200 amp Service Panel
- Extra Conduit from Electrical panel Through Floor
- Extra Telephone/T.V. Jack(s)
- Air Conditioner-Ready Furnace
- Air Conditioning Unit
- Electric Furnace c/w 200 amp Panel
- Oil Gun Furnace
- Oil Gun Furnace-Air Condition Ready
- 40 Gal. Convertible Gas Water Heater

Authorized Retailer:



P.O. Box 845, #200 Highway 18 West  
Estevan, SK S4A 2A7  
[www.shelterhomes.ca](http://www.shelterhomes.ca)